

Pensiero Computazionale

Per la scuola dell'infanzia e la scuola primaria

Ottobre 2018



<https://ozoblockly.com/>

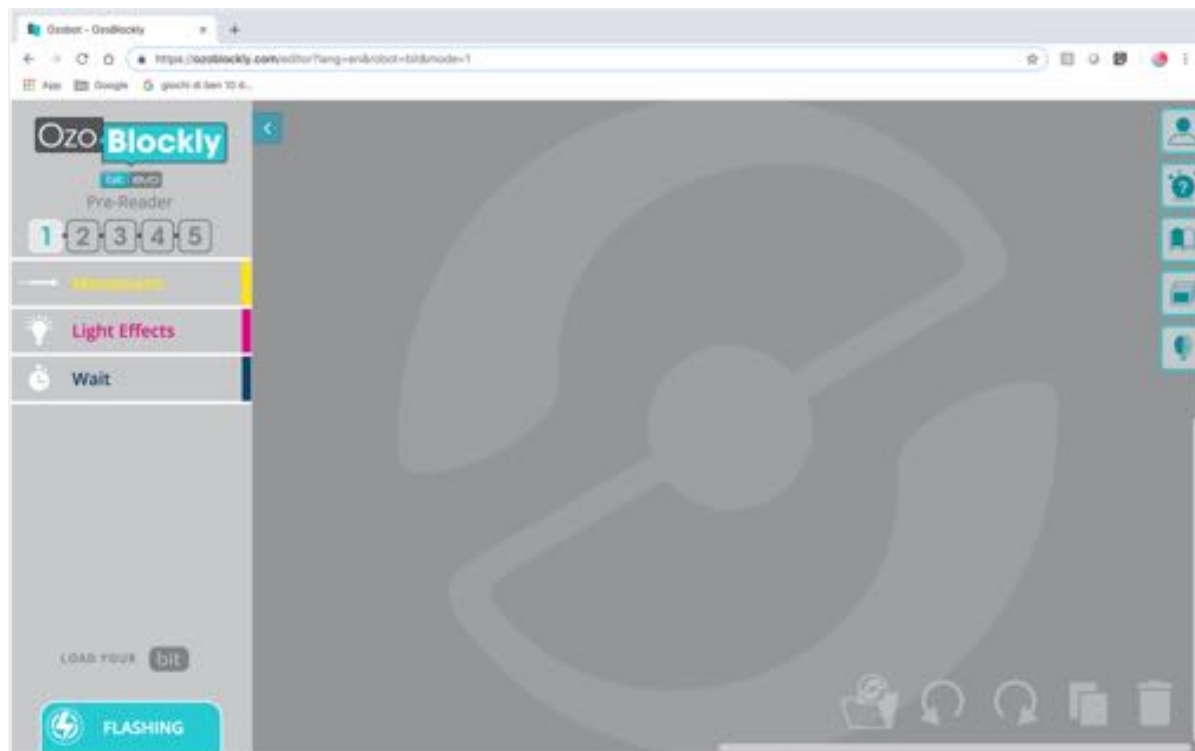

OzoBlockly - Bit-Evo

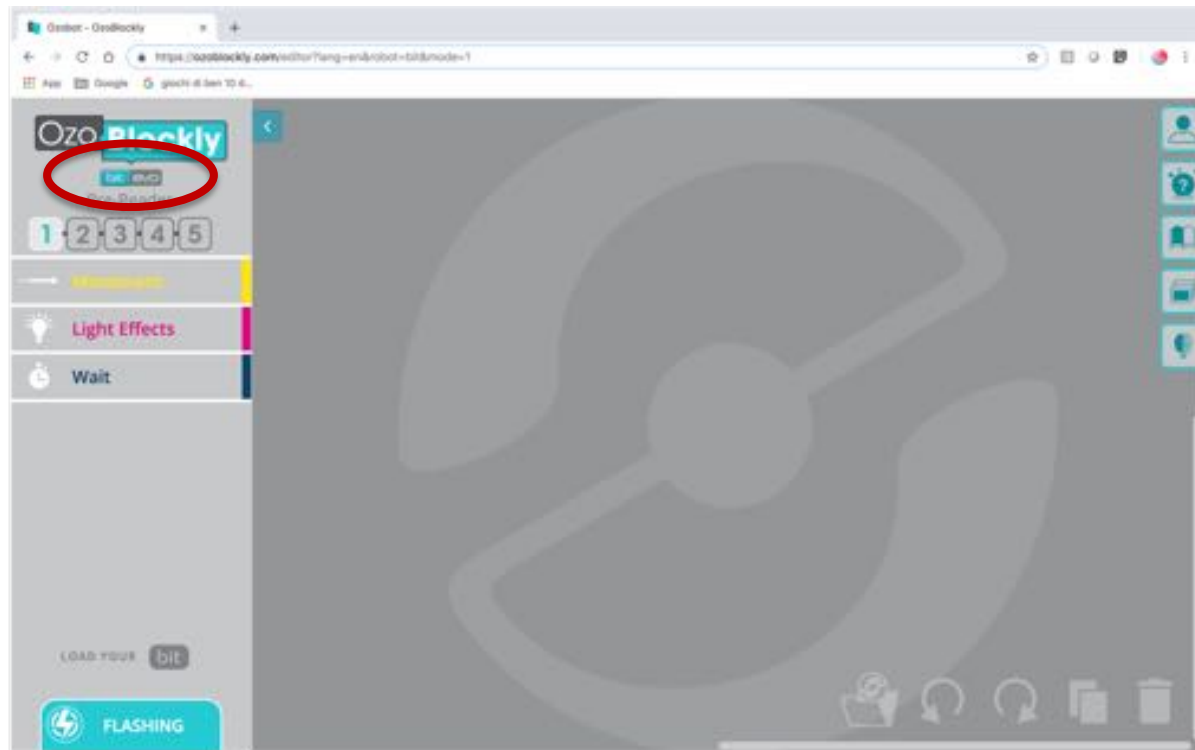

OzoBlockly - Bit-Evo

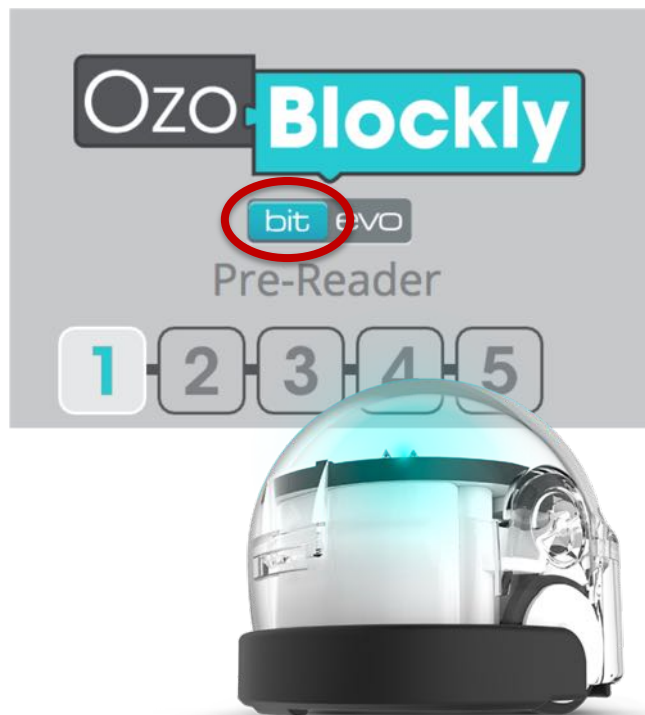

OzoBlockly - Bit-Evo

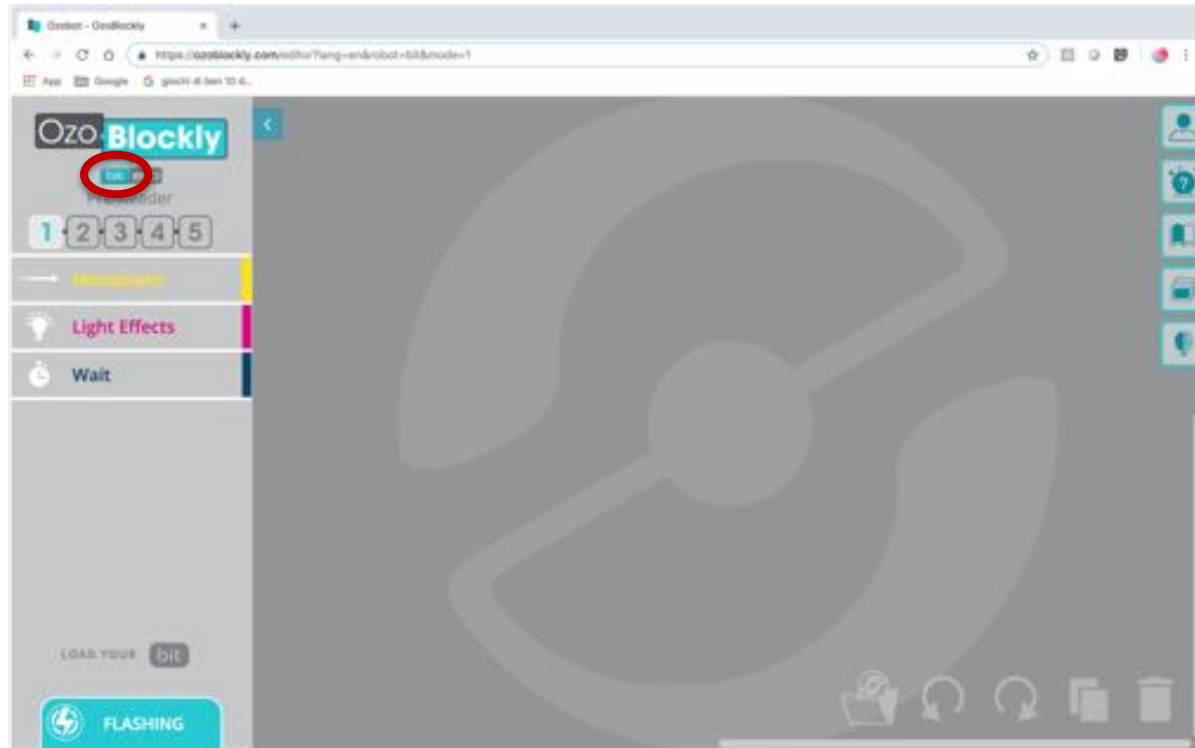

OzoBlockly - Bit-Evo

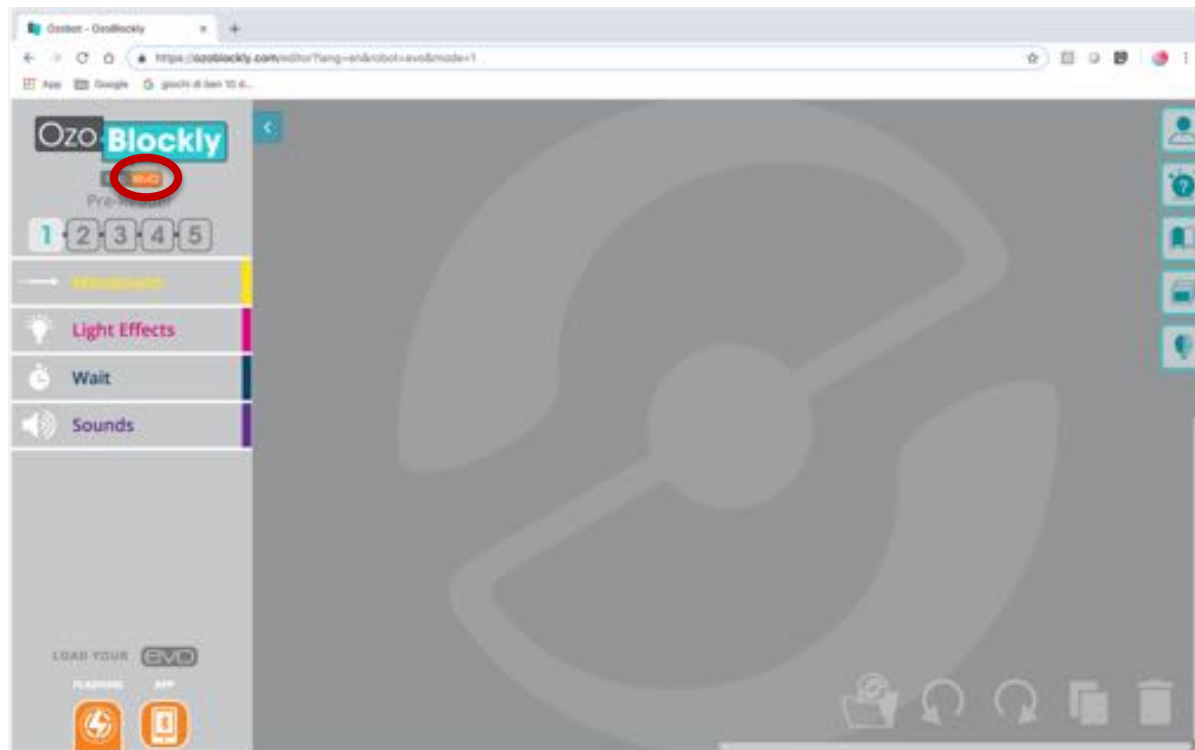

OzoBlockly - Livelli

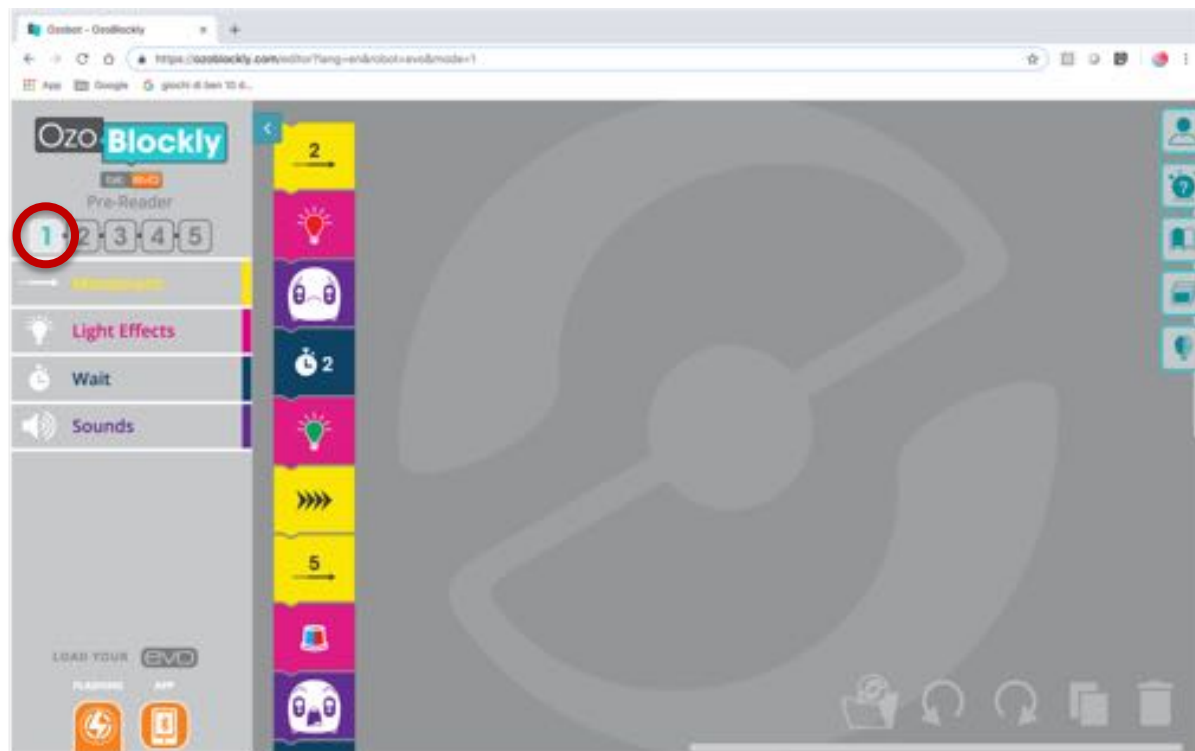

OzoBlockly - Livelli

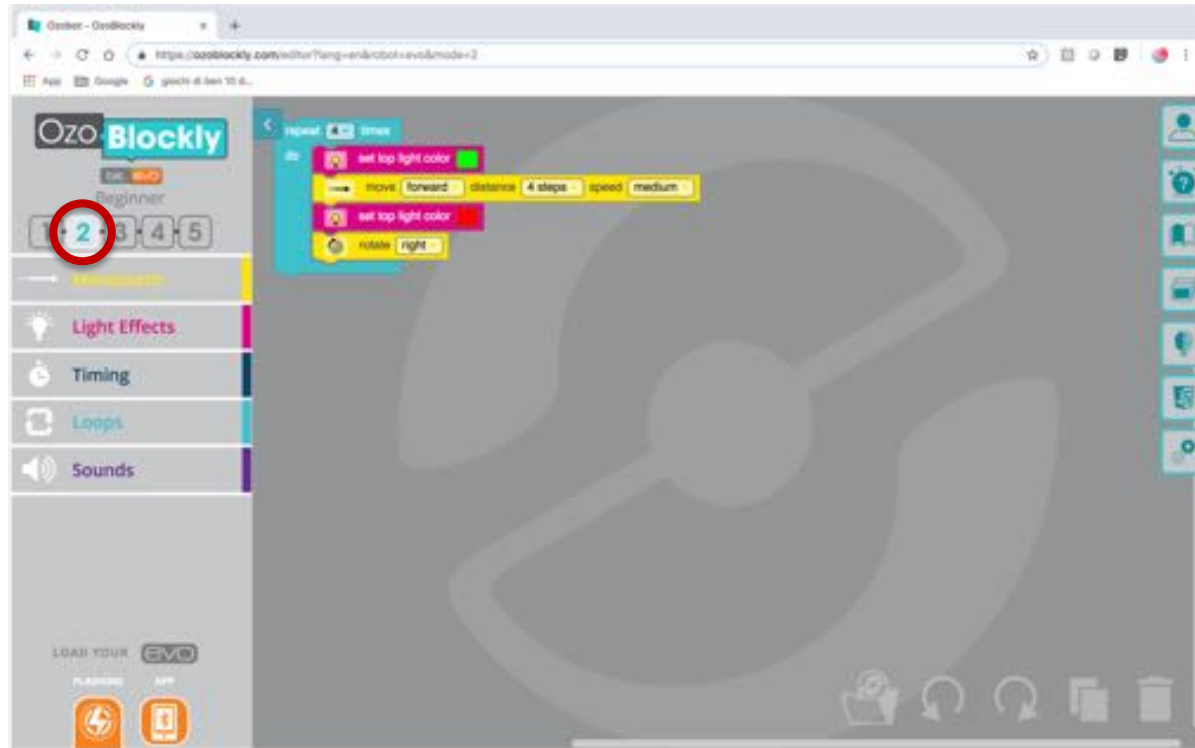

OzoBlockly - Livelli

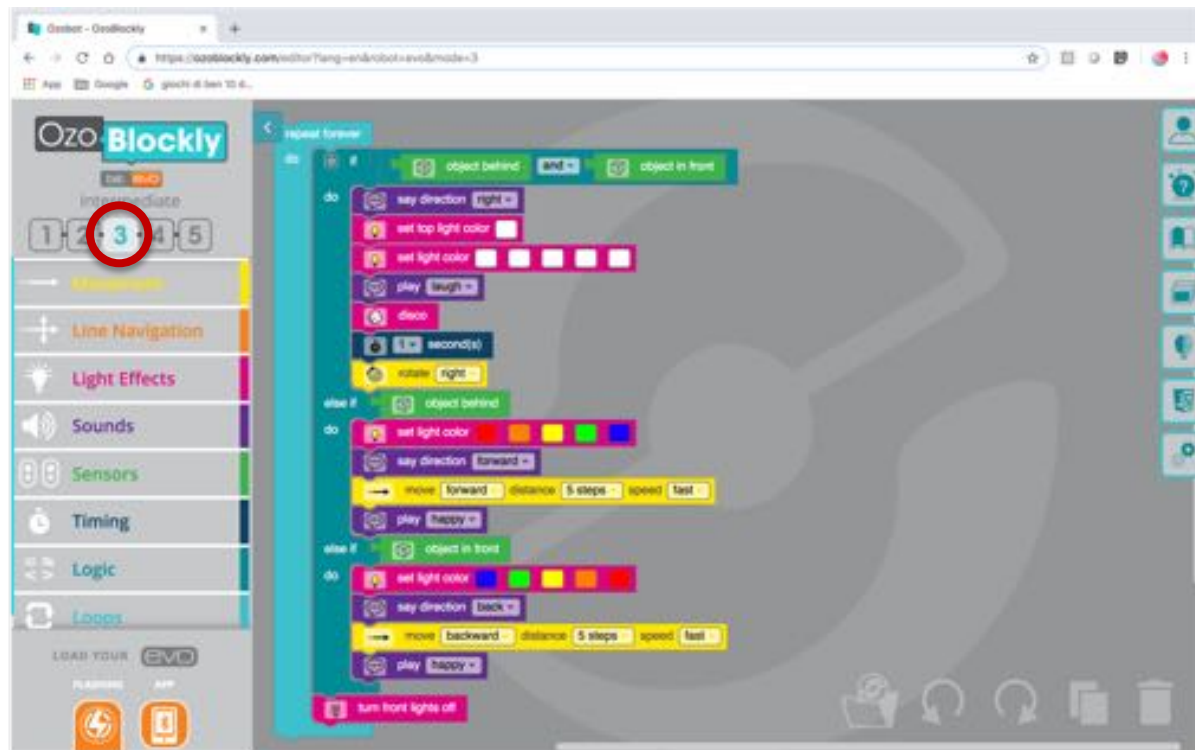

OzoBlockly - Livelli

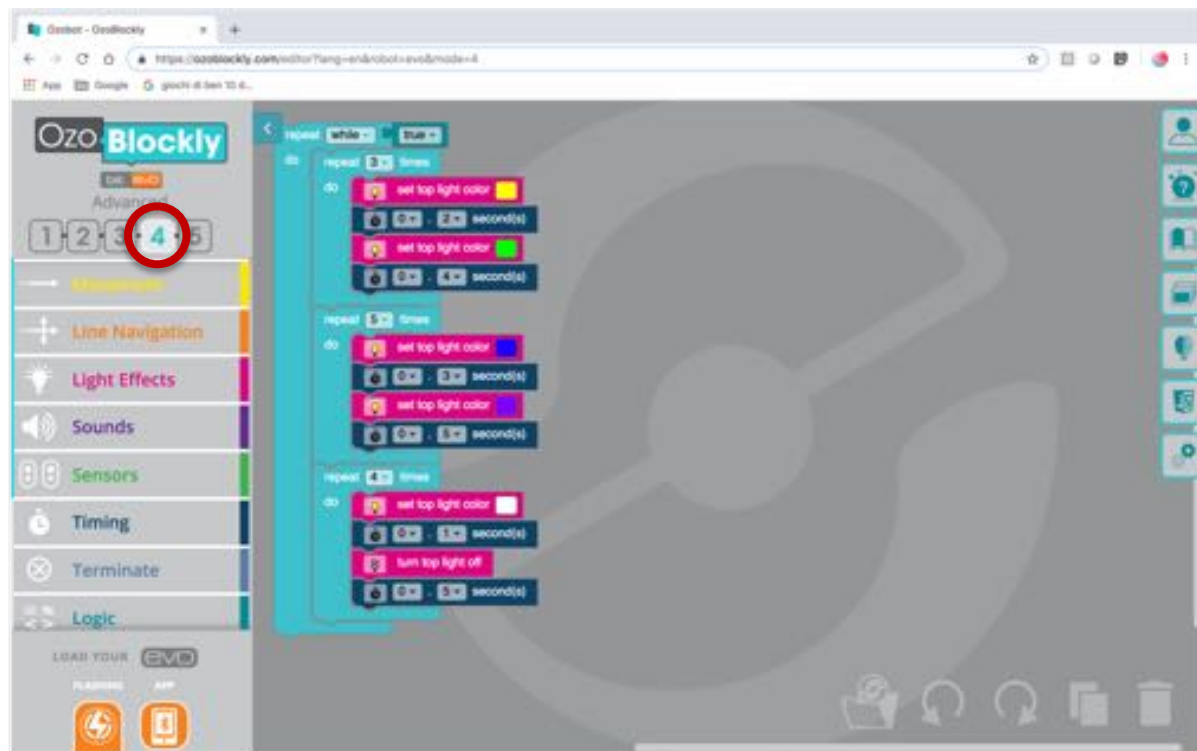

OzoBlockly - Livelli



OzoBlockly - Programmazione Ozobot Evo

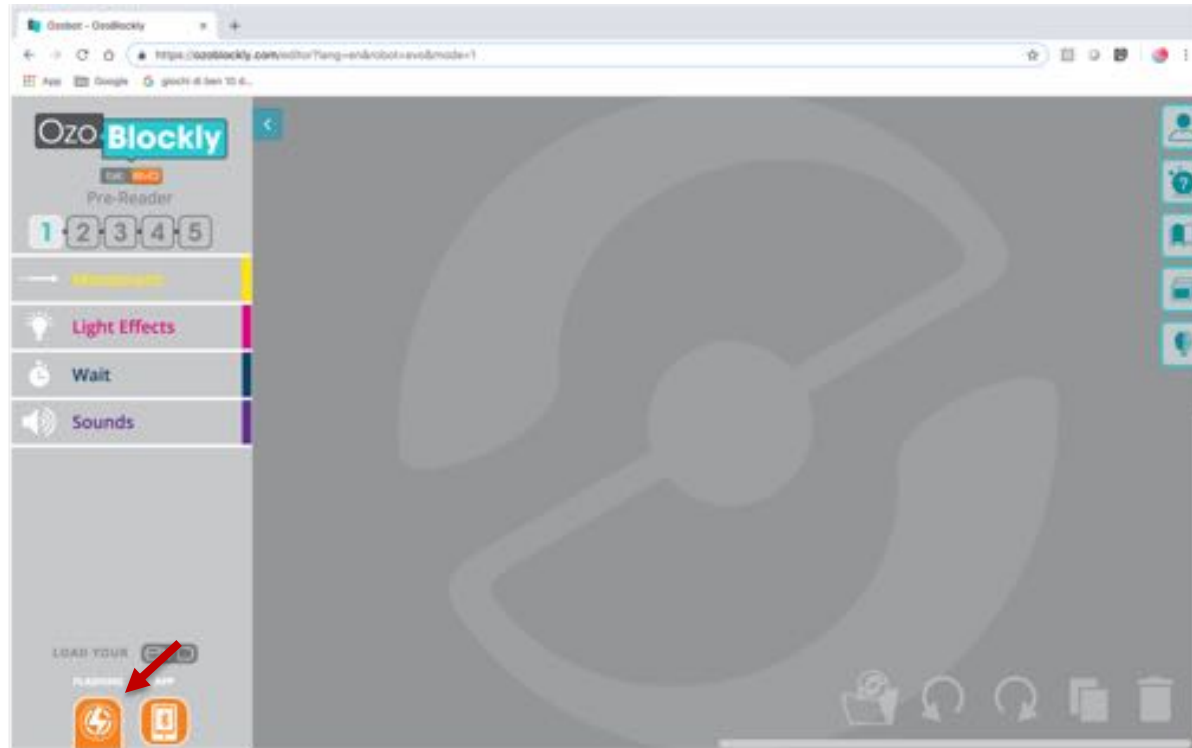

OzoBlockly - Programmazione Ozobot Evo

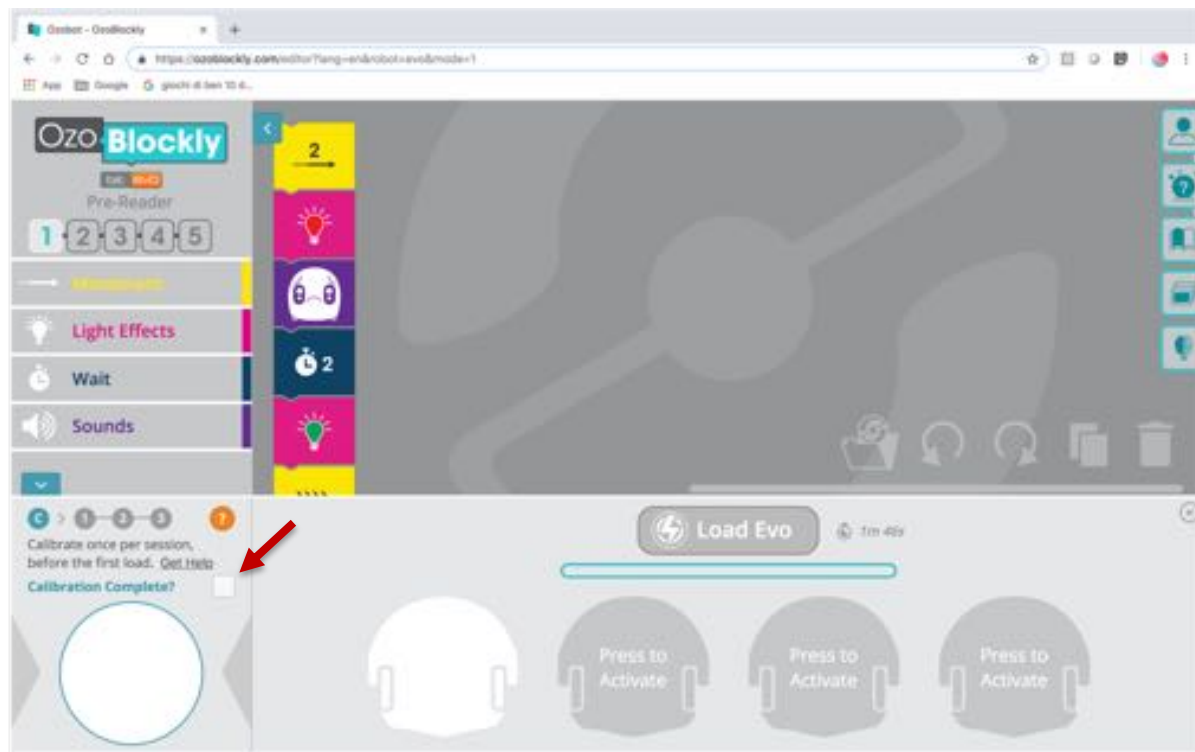

OzoBlockly - Programmazione Ozobot Evo

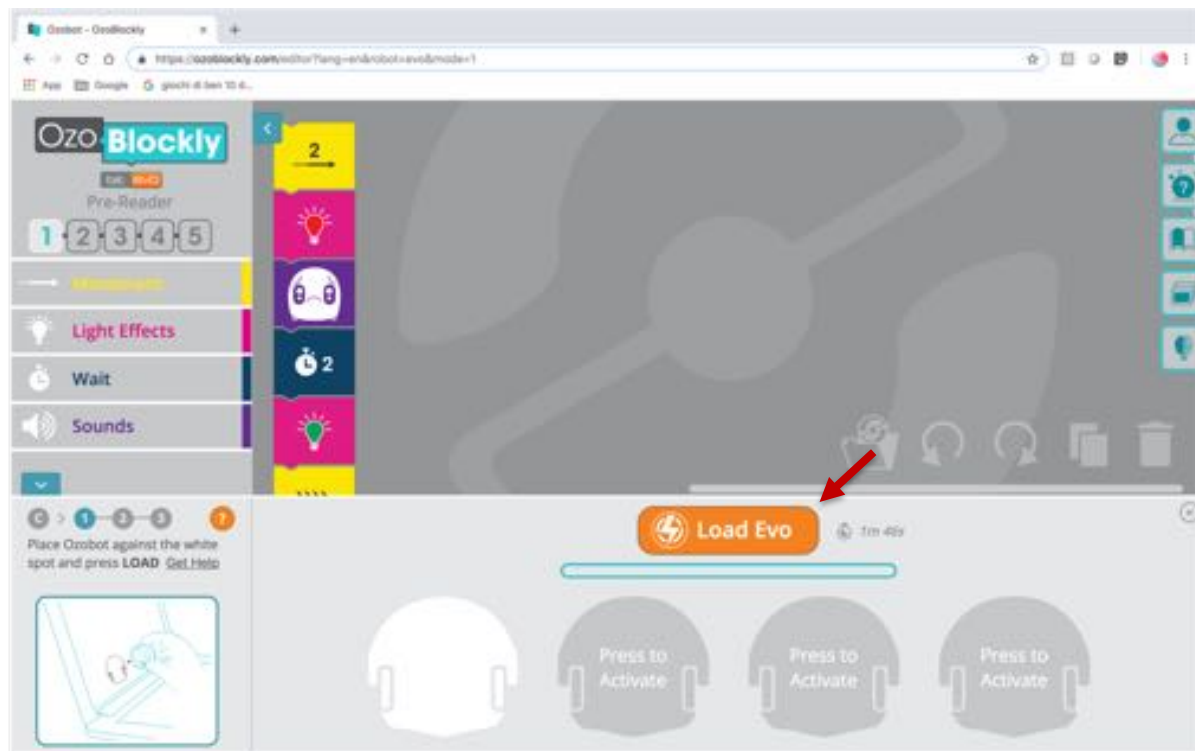

OzoBlockly - Programmazione Ozobot Evo



OzoBlockly - Salvataggio del programma

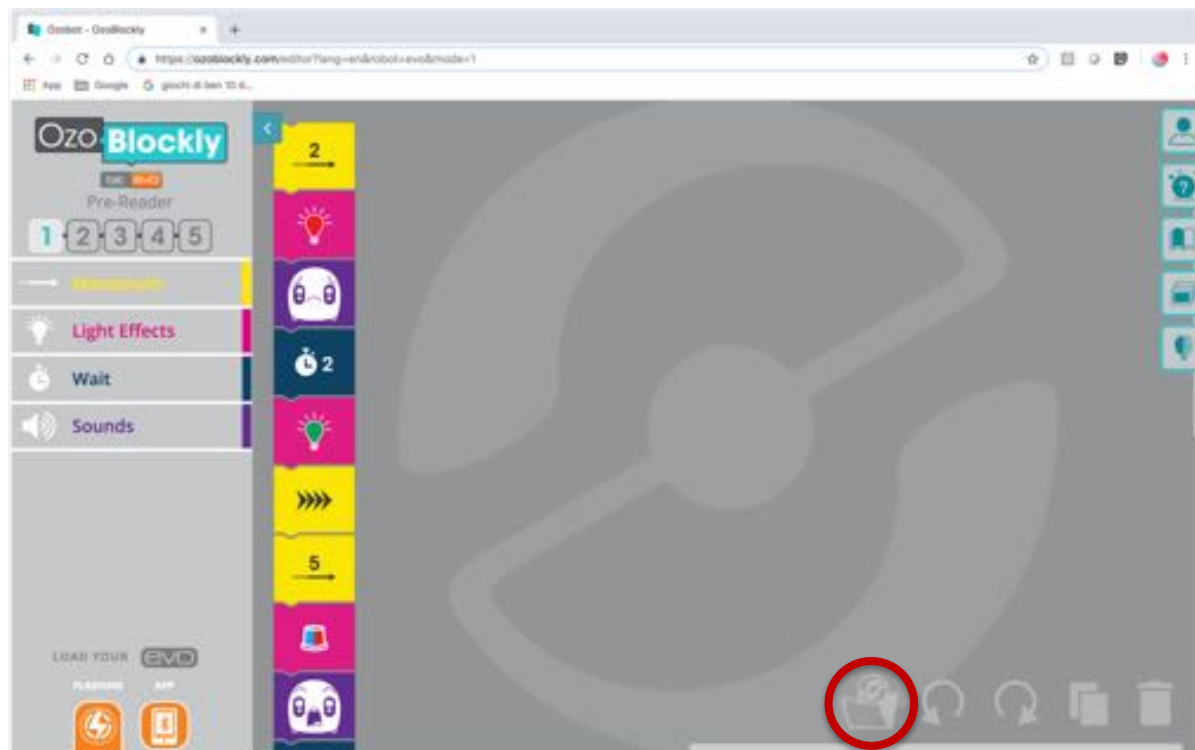

OzoBlockly – Salvataggio del programma

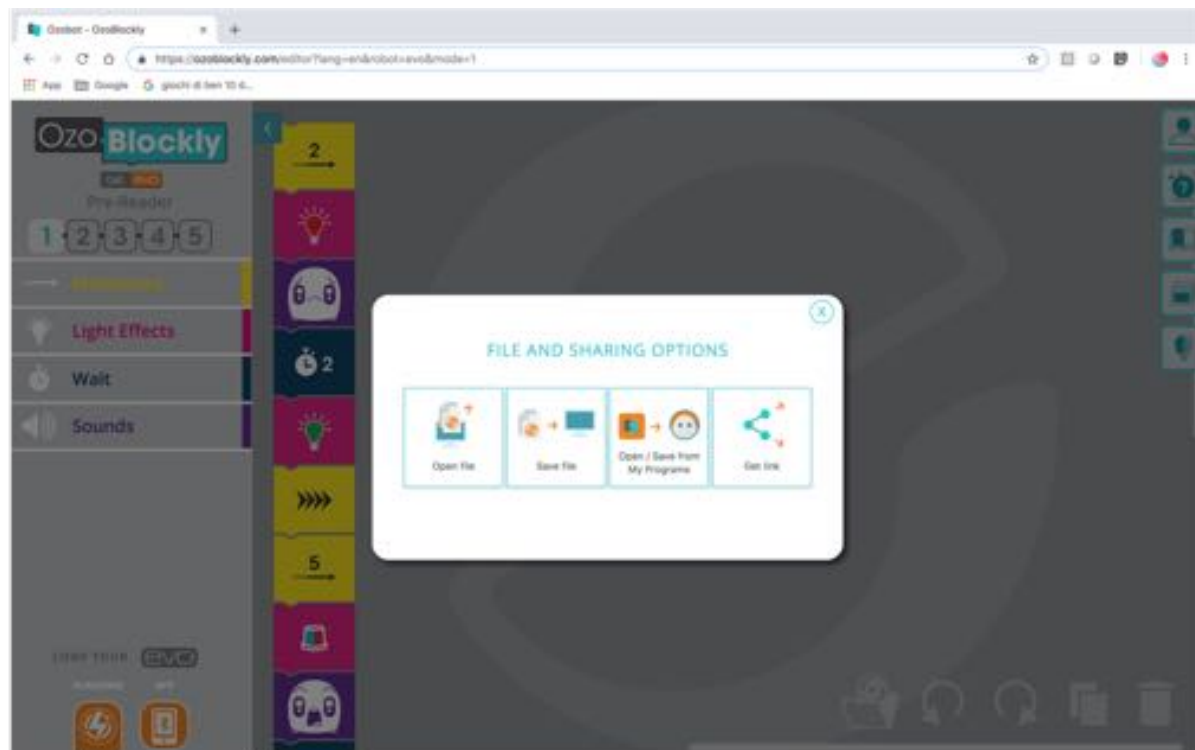

OzoBlockly - Schede - Profilo utente

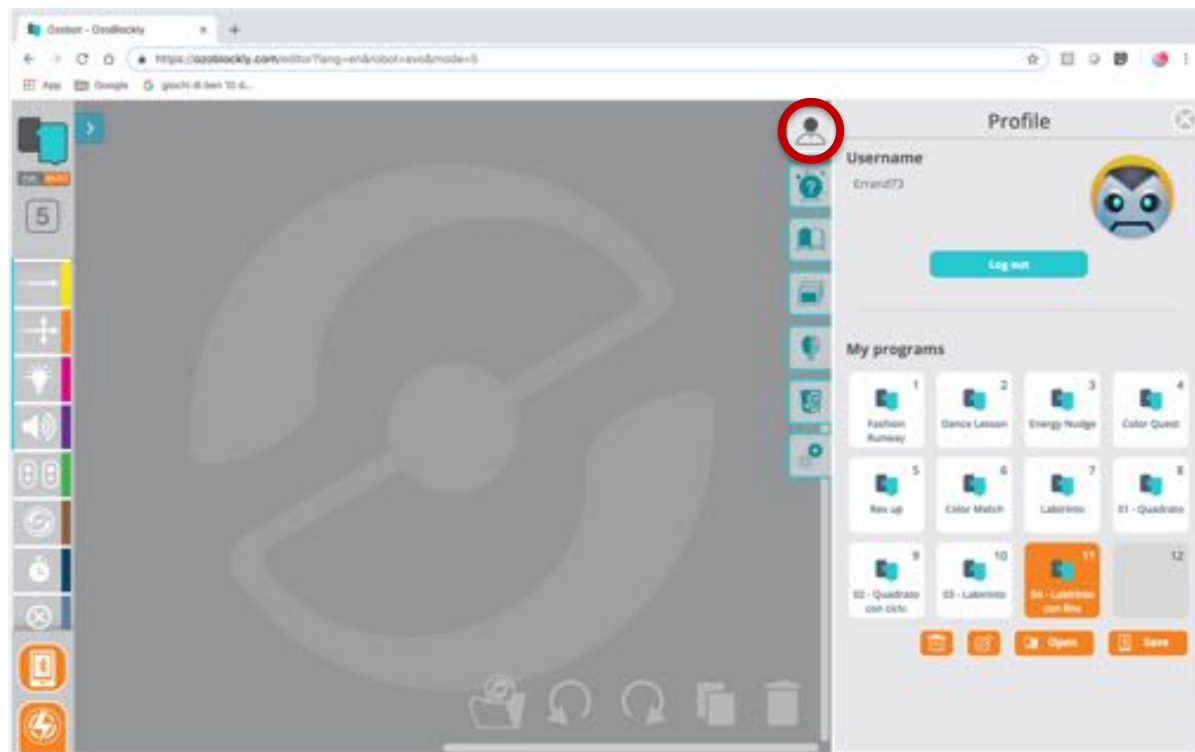

OzoBlockly - Schede - Tutorial

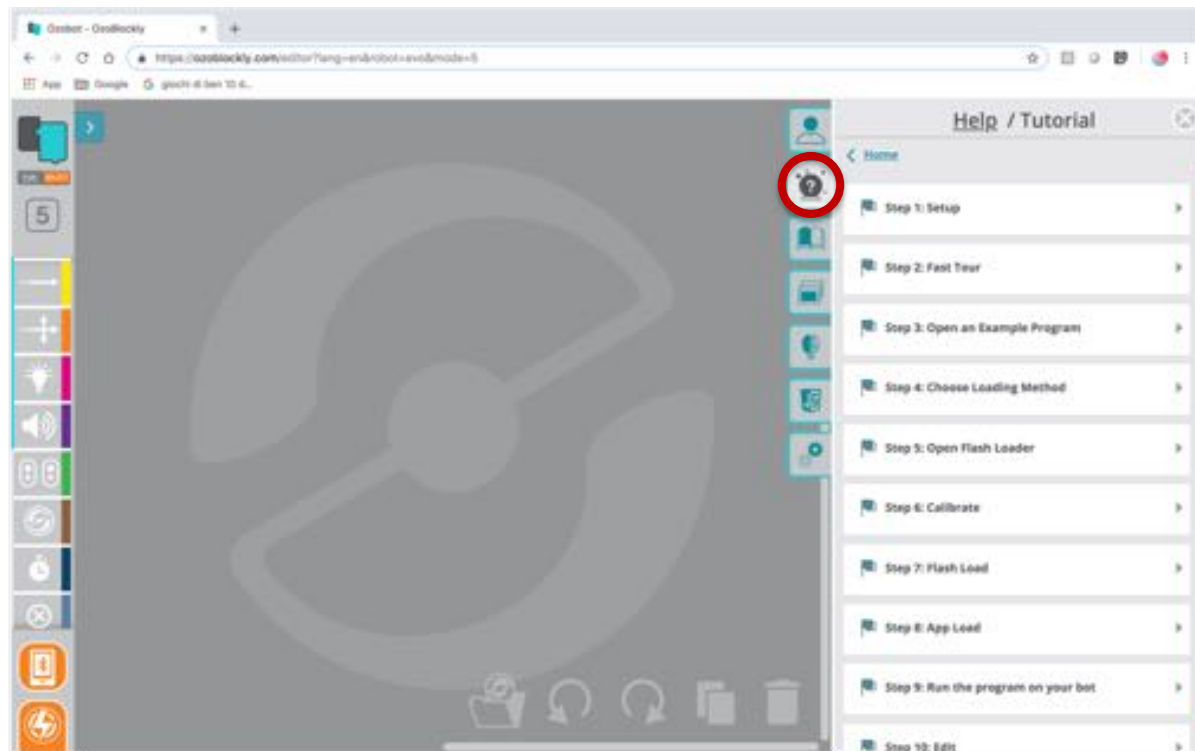

OzoBlockly - Schede - Help contestuale

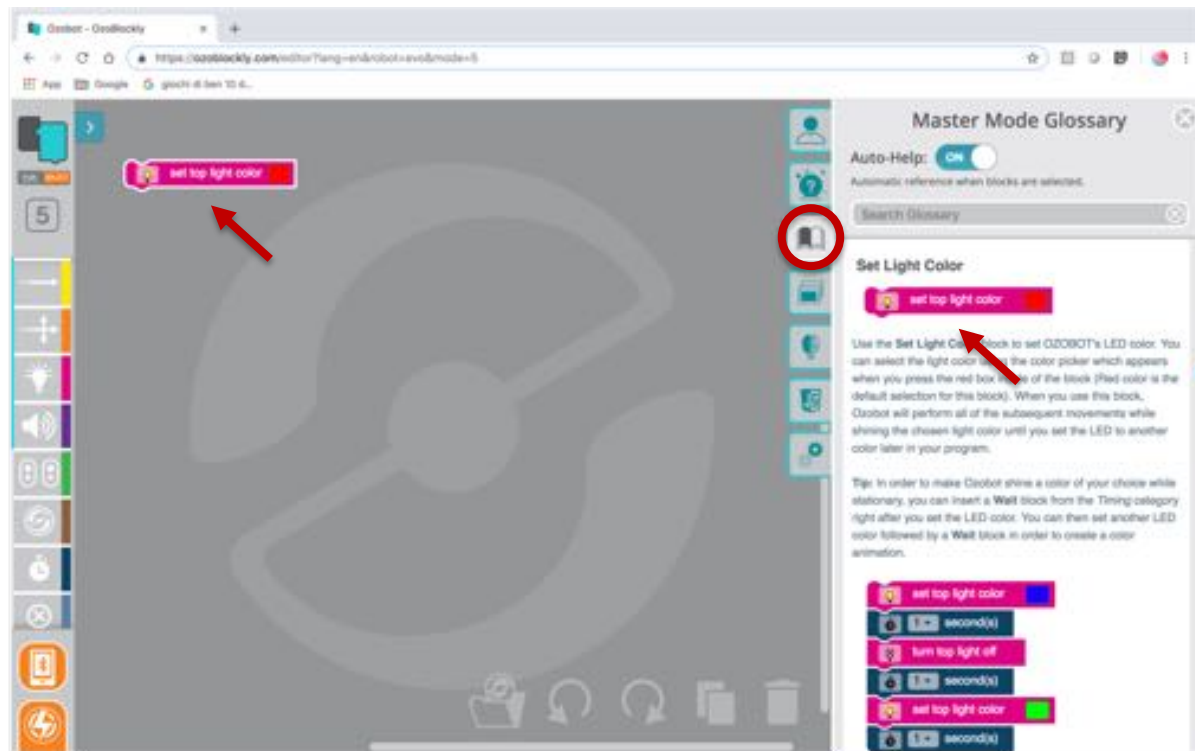

OzoBlockly - Schede - Esempi

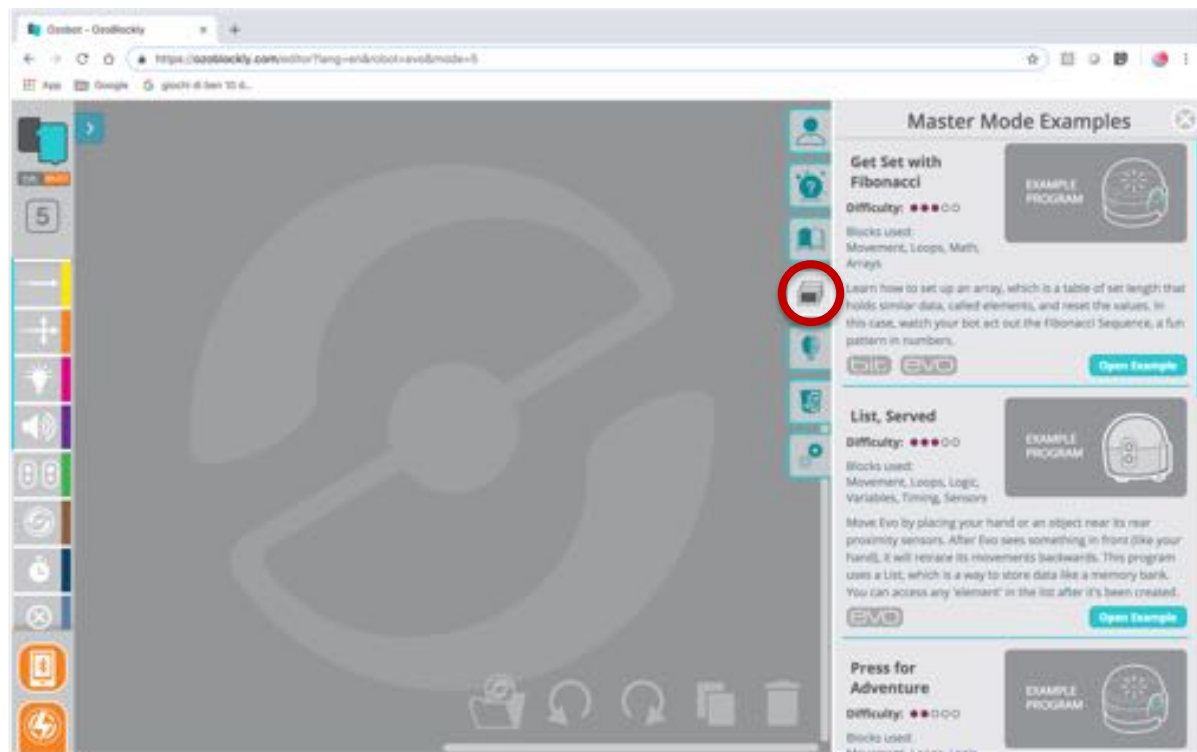

OzoBlockly - Schede - Esercizi proposti

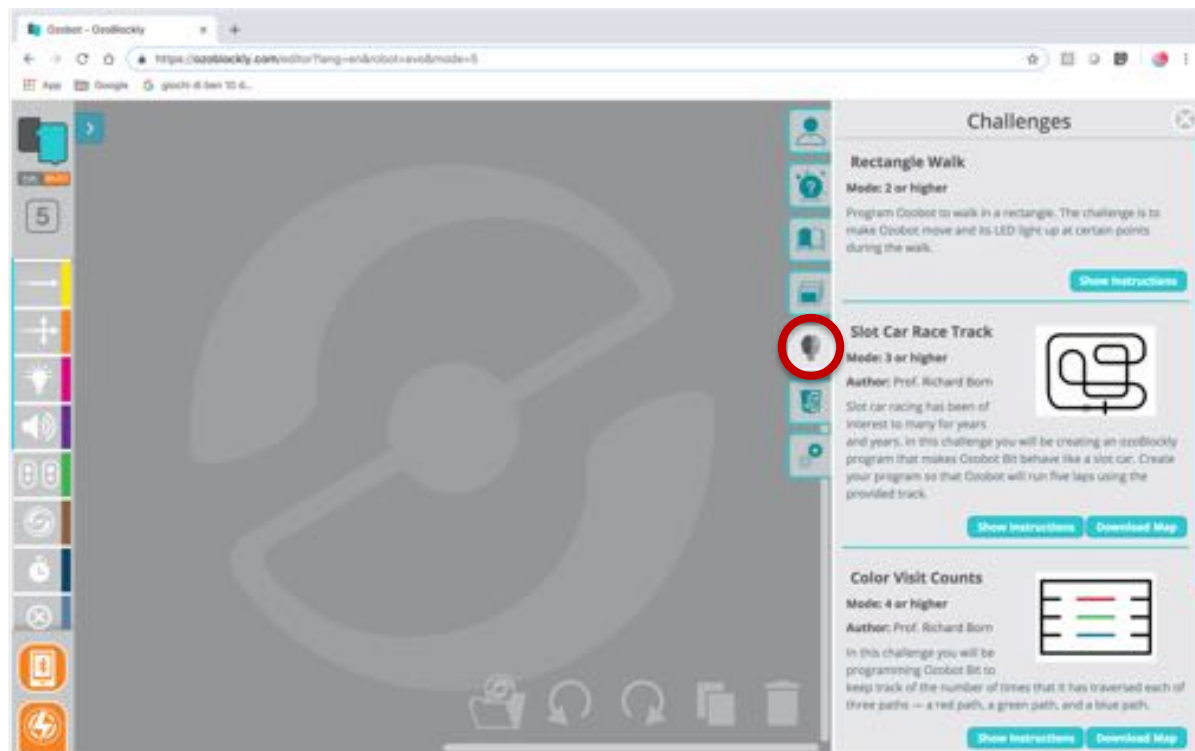

OzoBlockly - Javascript Preview

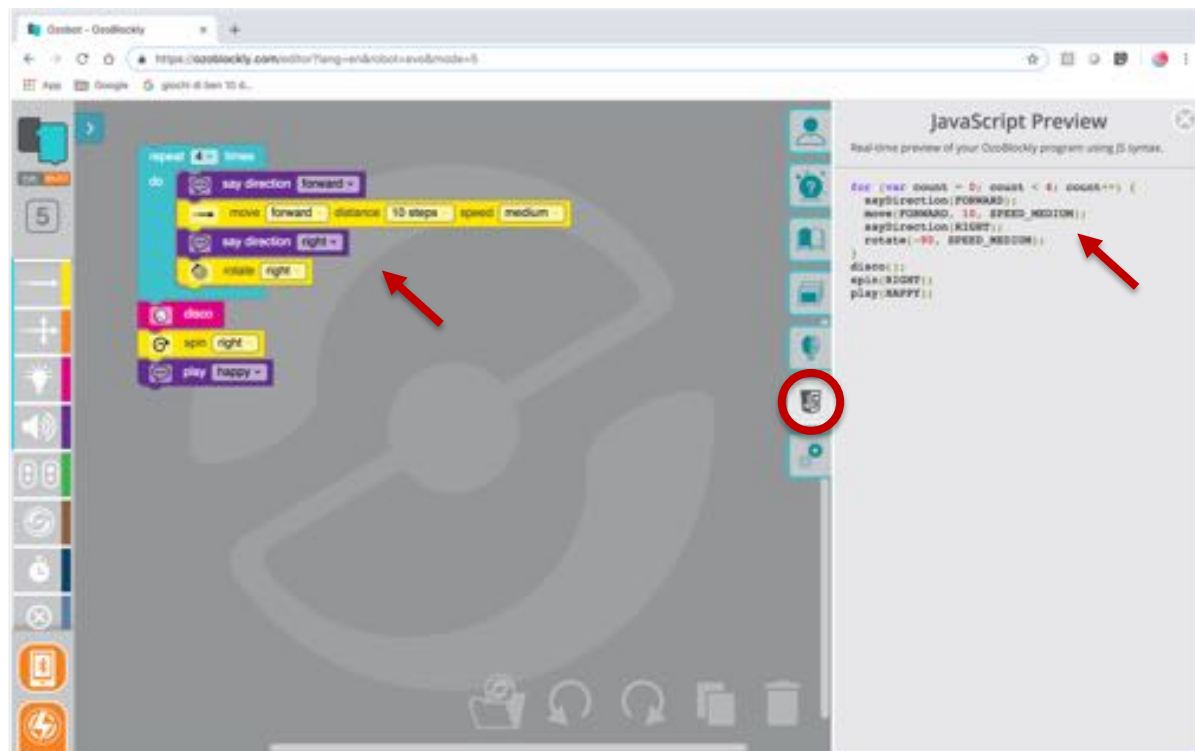

OzoBlockly - Schede - Impostazioni

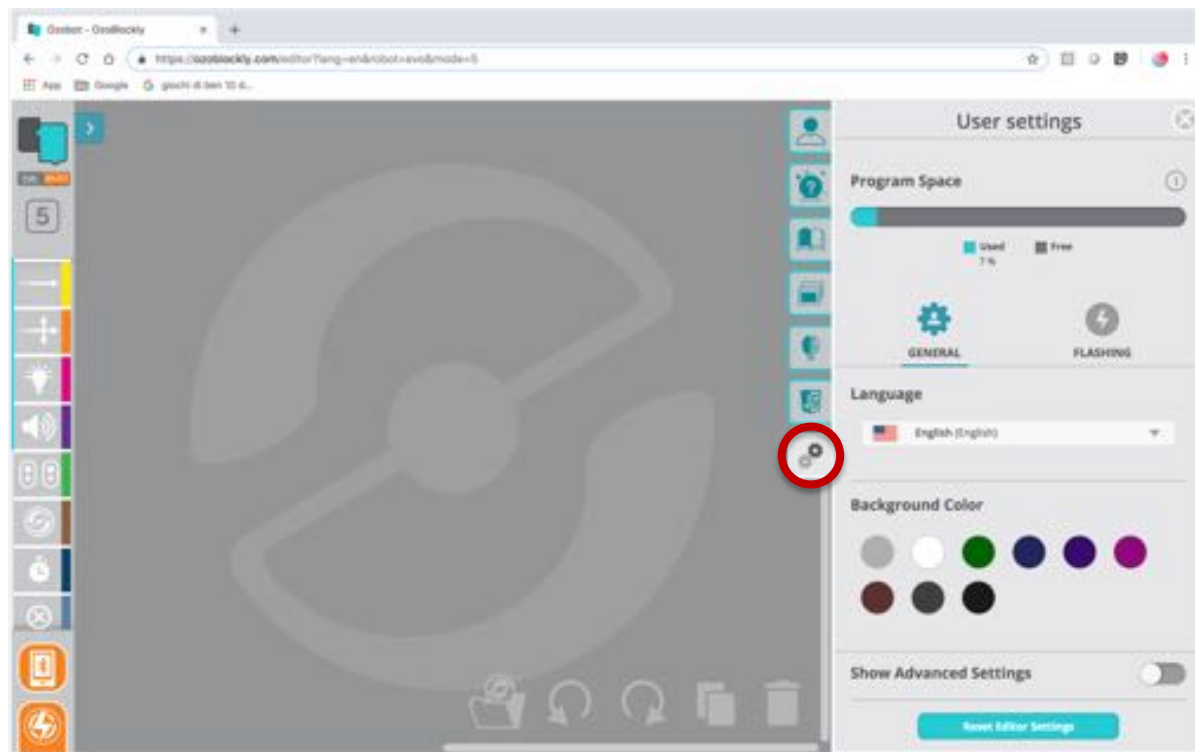

Calibrazione su carta

PAPER CALIBRATION

1

Make sure Ozobot is powered off, then place it in a black circle slightly bigger than Ozobot. If you are using markers, create this circle using a black marker.



2

Press & hold Ozobot's Power Button for 2-4 sec. until top light blinks white. Then, release Power Button.



3



Ozobot blinks green when calibrated. If Ozobot blinks red, start over from step 1. Evo also spins during calibration.

4



Press the Power Button to turn Bit back on. Evo powers on automatically after calibrating.

Calibrazione su schermo

DIGITAL CALIBRATION



Set your screen brightness to 100% and make sure the auto-brightness feature is turned off on your tablet or computer screens.



Place Ozobot against a white section of the screen (i.e. the calibration circle in OzoBlockly)



Press & hold Ozobot's Power Button for 2-4 sec. until top light blinks white. Then, release Power Button.

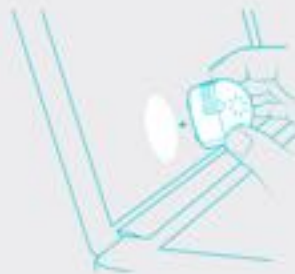

When Ozobot blinks green, it means that it has successfully calibrated. Start over if Ozobot blinks red.



Evo by Ozobot



Edu Utility
Updater



Pulsante di accensione

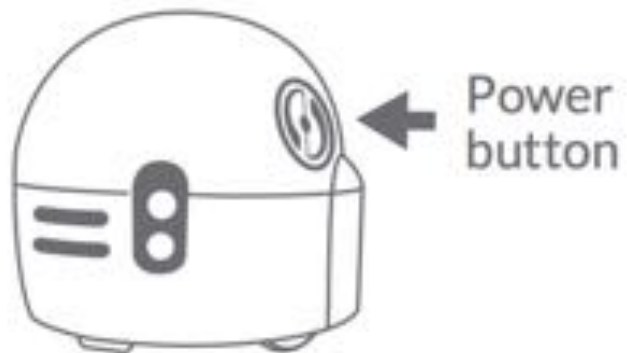

Single Click	Double Click	Press and Hold
Power On/Off	Run programs	Calibrate

Esecuzione programma

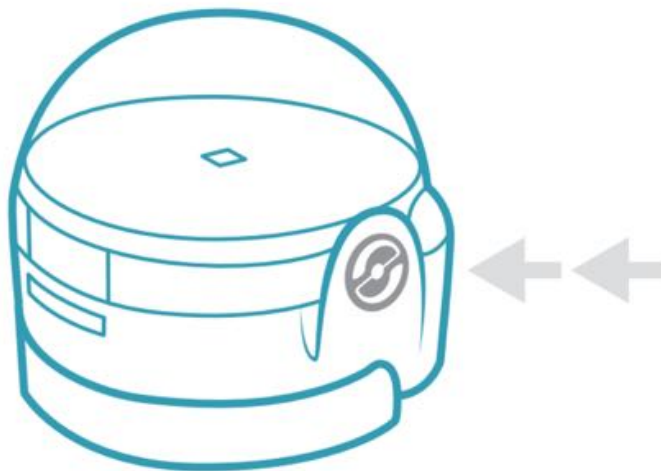



BOT BASICS

<https://files.ozobot.com/stem-education/educator-botcamp.pdf>

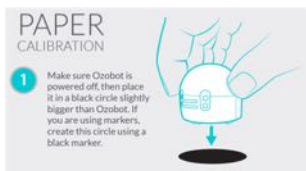

ozobot edu CALIBRATION TIPS

<https://ozobot.com/stem-education/education-getting-started>

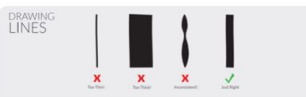

ozobot edu COLOR CODE TIPS

<https://files.ozobot.com/stem-education/ozobot-tips.pdf>



COLOR CODES

<https://files.ozobot.com/stem-education/ozobot-color-codes.pdf>

GRAZIE.

flavio.renga@fondazione scuola.it

www.riconessioni.it